



*Appendix
(see appendix file)*



Acronyms

AcFin	Academic and Financial Plans
AP	Advanced Placement
ASK	Associated Students of Kalaheo
BYU	Brigham Young University – Hawai'i
CSSS	Comprehensive Student Support System
CTE	Career and Technical Education
DOE	Hawai'i State Department of Education
eCSSS	Electronic Comprehensive Student Support System
eSIS	Electronic Student Information System
ELL	English Language Learners
GLOs	General Learner Outcomes
HCPS III	Hawai'i Content Performance Standards III
HQ	Highly Qualified
HQT	Highly Qualified Teacher
HSA	Hawai'i State Assessment
IDEIA	Individuals with Disabilities Education Improvement Act
IEP	Individualized Education Program
JVEF	Joint Venture Education Forum
NJROTC	Naval Junior Reserve Officers' Training Corps
PD	Professional Development
PTP	Personal Transition Plan
PTSA	Parent Teacher Student Association
RTI	Response to Intervention
SCC	School Community Council
SLC	Smaller Learning Communities
SPED	Special Education
WASC	Western Association of Schools and Colleges
WSF	Weighted Student Formula

KHS Faculty and Staff

Administration			
Susan Hummel	Principal		
Ginny Stroud	Vice Principal		
Paloma Almanza	Vice Principal/WASC		
Resha Ramolete	Vice Principal	Counseling	
Mark Brillhante	Athletic Director	Joy Kahahawai Welch	A-G Counselor
Faculty	Depart/Home Gp	Vicky Kamaka	H-O Counselor
Stephen Ansley	Social Studies	Colleen Cashman Valdez-DH	P-Z Counselor
Timothy Anthony	ELA	April Inouye	CCC Counselor
Jacob Baum-DH	Social Studies	School-Based Behav. Health	
Allan Blythe	SPED	Gina Hood	BHS/Counseling
Maria Cavalcante-Fleming	SPED	Rueben Ingram	BHS/Counseling
Laura Chandler	SPED		
Jose Colon	NJROTC	Support Staff (Certificated)	
Katlin Connell	Science	Richard Lau	Stud. Act. Coord
Robert Davids	Social Studies	Kim Shinno	Registrar
Catherine Dichner	CTE	Barbra Taylor	SSC
Arthur Fitchet	CTE		
Jerilyn Florimonte-dh	Fine Arts		
Stacie Friel	SPED	Support Staff (Classified)	
Danielle Fujii	Librarian	Catherine Rose	Athletic Trainer
Kristine Giannasio	World Language/ELL	Kristie Tokushige	Athletic Trainer
Phil Gilsdorf	Science	Alfred Kahana	Café Manager
Tara Gumapac	Fine Arts	Justina Soon	Café Baker
Kristin Haine	PE	Kimberly Nakoa	Café Cook
David Hughes	On-line/Hybrid	Lilia Kaleleiki	Head Custodian
Rita Kalaukoa	Social Studies	Cecilia Rivera	Custodian
Kalehua Kamakawiwoole	ELA/ELL	Marlyn Duque	Custodian
Kristin Haine	PE/Health	Gann Fernandez	Custodian
Maile Kawabata	Science	Guy Liftee	Custodian
Glenn Kidani	Fine Arts	Raymond Seabury	Custodian
Gary Kikuchi	Math	Mary Suphan	Ed. Asst
Kasey Ko- DH	Language Arts	Robert Suphan	Ed. Asst.
Kimberly Koopman-DH	Science/Acad Coach	Joyce Ing	Ed. Asst.
Karen Mack Hunt	SPED	Justin Smith	Ed. Asst.
Christopher Mellor	PE	Kathy Fukunaga	Ed. Asst.
Cara Middlesworth-DH	SPED	Clorinda Manini	Ed. Asst.
Martha Morrissey	ELA	Regina Okuyama	Ed. Asst.
Lori Nishimura-DH	CTE	Joyce Ing	Ed. Asst.
Amanda Newman	Science	Jolene Kitchens	Ed. Asst.
Bethann Paul	SPED	Carlene Atwater	Registrar clerk
Vanessa Pickart	World Languages	Teather	Health Aide
Mary Kate Powers	Social Studies	Susan Zuttermeister	Office Clerk
Micah Pregitzer	Science	Joan Lines	Office Clerk
Polly Quigley	Technology Coord	Josette Soares	Acct. Clerk
Sue Radell	SPED		SSC Clerk
Steven Rusk	SPED	Dominique Miles	SASA
Krystal Sato	ELA	Margaret Gammon	PCNC
Christina Shaffer	CTE	Erik Ivaska	Teen Care
Kathy Shigemura	CTE	Billi Jo Aloiau	Security
Crystal Stafford	Science	Blossom Aweau	Security
Stuart Sugasawara	Math	Greg Miranda	Security
Luseanne Suliafu	ELA		
Doris Taitano	SPED		
Kwong Tan	Math		
Jeanine Taylor	ELA		
Julie Tzucker-Nikolas	SPED		
Henry Van Oss	NJROTC		
Kyle Wachi	World Languages		
Ryan Williams	Math		

Art Wong

Fine Arts

**KHS Focus Groups
2015-2016**

A: Organization: Vision, Mission, General Learner Outcomes, Governance, Leadership and Staff, and Resources
Science- Kim Koopman
Fine Arts –Jerylin Florimonte
CTE – Lori Nishimura
Math – Kwong Tan
Social Studies – Jacob Baum
SPED – Cara Middlesworth
Administration- Susan Hummel
Administration- Paloma Almanza

B1 :Standards-based Student Learning: Curriculum
Social Studies – Jacob Baum
Language Arts – Luseanne Suliafu
Math – Stuart Sugasawara
NJROTC- Jose Colon
Science- Micah Pregitzer
SPED – Laura Chandler
Fine Arts- Tara Gumapac
SSC- Barbra Taylor
Hybrid- David Hughes
World Languages- Vanessa Pickart
Registrar- Kimberly Shinno

B2/3: Standards-based Student Learning: Curriculum
ELA- Krystal Sato
CTE – Arthur Fitchett
SPED-Karen Mack Hunt
PE – Christopher Mellor
Science – Amanda Newman
Social Studies – Rita Kalaukoa
Counselor- Vicky Kamaka
Math- Gary Kikuchi
SAC- Richard Lau
Tech Coordinator- Polly Quigley
CTE- Tina Shaffer
SPED- Doris Taitano

C: Standards-based Student Learning: Instruction
Science- Kim Koopman
Social Studies - Stephen Ansley
ELA- Timothy Anthony
Counselor-Colleen Cashman-Valdez
World Languages- Kristine Giannasio
Science- Phil Gilsdorf
PE- Kristin Haine
ELA- Martha Morrissey
SPED- Bethann Paul
SPED- Sue Radell

D : Standards-based Student Learning: Assessment and Accountability
CTE- Lori Nishimura
SPED- Allan Blythe
Social Studies- Robert Davids
CTE- Catherine Dichner
Counselor- Joy Kahahawai Welch
Fine Arts- Glenn Kidani
P.E.- Kasey Ko
SPED- Steven Rusk
Science- Crystal Stafford
Math- Kwong Tan
ELA -Jeanine Taylor
SPED- Julie Tzucker-Nikolas
NJROTC- Henry Van Oss

E : School Culture and Support for Student Personal and Academic Growth
Fine Arts- Jerylin Florimonte
P.E.- Chris Akana
SPED- Maria Cavalcante-Fleming
Science- Kaitlin Connell
Social Studies – MaryKate Powers
SPED – Stacie Friel
Counselor- April Inouye
ELA- Kalehua Kamakawiwoole
Science-Maile Kawabata
SPED- Cara Middlesworth
CTE- Kathy Shigemura
World Languages- Kyle Wachi
Teen Care- Erik Ivaska

Staff focus groups
Athletic Director : Mark Brillhante
Office Clerks and Cafeteria staff : Dominique Miles, Susan Zuttermeister, Carlene Atwater, Josie Soares, Joan Lines, Al Kahana, Tina Soon, Kimberly Nakoa
Custodial and Security staff : Lilia Kaleleiki, CeCe Rivera, Gann Fernandez, Guy Liftee, Raymond Seabury, Marlyn Duque
Student focus groups:
Arthur Fitchett period 5 Industrial/Engineering Tech Path Core students
Kathy Shigemura period 6 Arts/Communication Path Core students
Kalaheo Student Senate

Math- Ryan Williams
Fine Arts- Art Wong

Kalaeo High Strive HI 2012-13 Step: Continuous Improvement Index Score: 299

Automatic Classification: None

Step 5 - All Schools

	Step 1	Step 2 - Unweighted Points	Step 3	Step 4 - Weighted Points	Step 5 - All Schools
Achievement	Math Proficiency 69% Math Achievement (Math Proficiency Rate) x (40pts)	28		28	
	Reading Proficiency 80% Reading Achievement (Reading Proficiency Rate) x (40pts)	32	72 pts of 100 pts Achievement (High School Weight) 72 x (1.0) = 72	32	72 pts of 100 pts
	Science Proficiency 61% Science Proficiency (Science Proficiency Rate) x (20pts)	12		12	
Growth	Math Median SGP 68 Math SGP Points assigned based on growth category	50	85 pts of 100 pts Growth (High School Weight) 85 x (0.6) = 51	30	51 pts of 60 pts
	Reading Median SGP 55 Reading SGP Points assigned based on growth category	35		21	
	11th Grade ACT 52% 11th Grade ACT (11th Grade ACT Rate) x (45pts)	24		47	
Readiness	Grad Rate 86% On-Time Graduation (Graduation Rate) x (50pts)	43	70 pts of 100 pts Readiness (High School Weight) 70 x (2.0) = 141	86	141 pts of 200 pts
	College-Going Rate 71% College-Going (College-Going Rate) x (5pts)	4		7	
	Non-High Needs Proficiency 79% High-Needs Proficiency 65% Gap Reduction 56% Current Year Gap Points assigned based on Current Year Gap Rate* * (NHN - HN) (NHN) Next Year Gap Reduction Points assigned based on Gap Reduction Rate* *(2010 gap - 2012 gap) / (2010 gap)	42	92 pts of 100 pts Achievement Gap (High School Weight) 92 x (0.4) = 37	17	37 pts of 40 pts
		50		20	
299 pts of 400 pts					

† Numbers may be rounded for presentation purposes.

Hawaii Public Schools School Year 2013-2014 Strive HI School Performance Report

Kalaeo High

School Year 2013-2014: Continuous Improvement
 School Year 2012-2013: Continuous Improvement

221 points of 400 points

Trigger: None

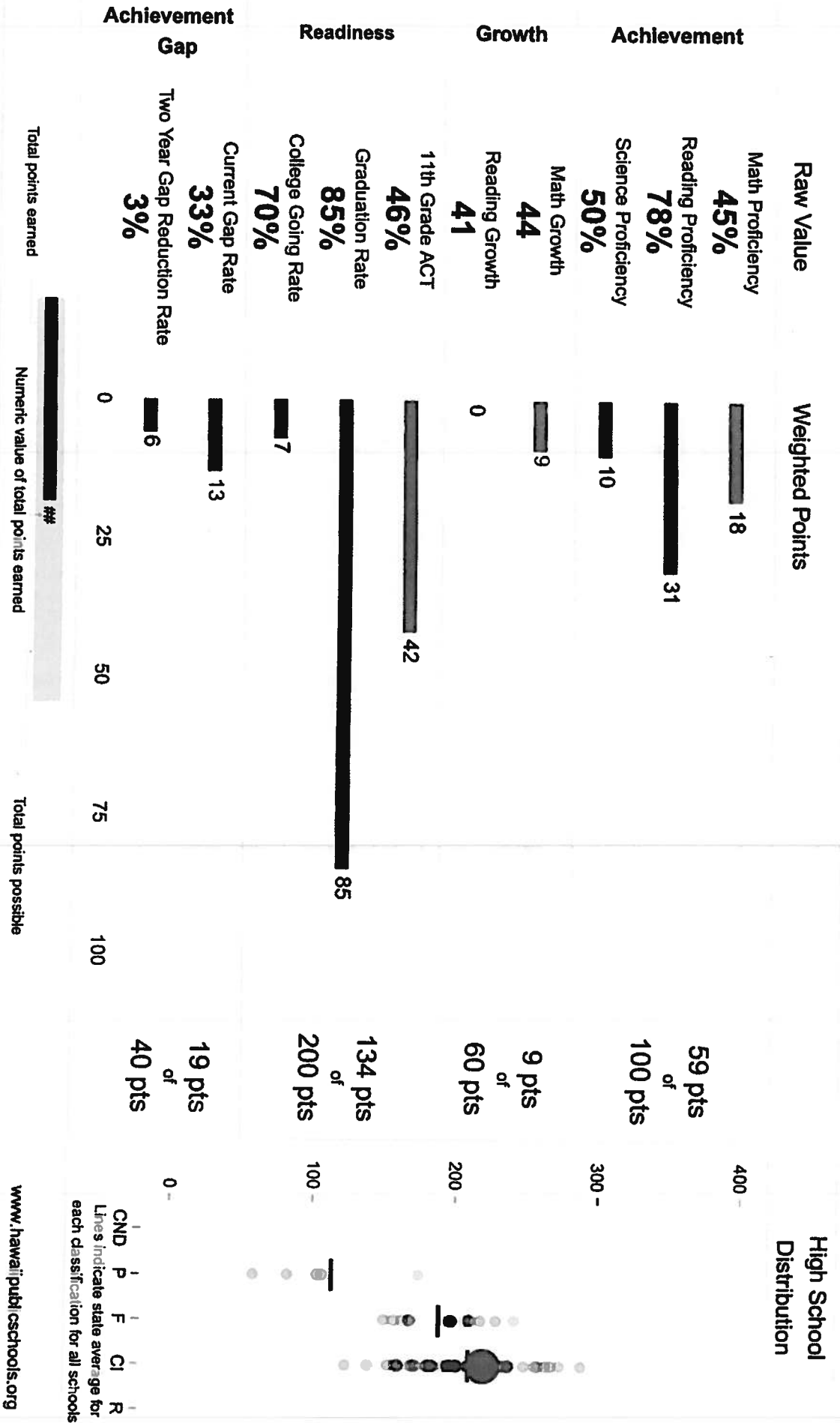

NOTE: Final display numbers are rounded, which may cause subtotals to appear to sum incorrectly. The total points value on the upper right is accurate.
 Run Date: Thursday, September 11, 2014 - Final Run

Hawaii Public Schools School Year 2014-2015 Strive HI School Performance Report

Kalaeo High

School Year 2014-2015: Continuous Improvement
 School Year 2013-2014: Continuous Improvement

230 points of 400 points

Trigger: None

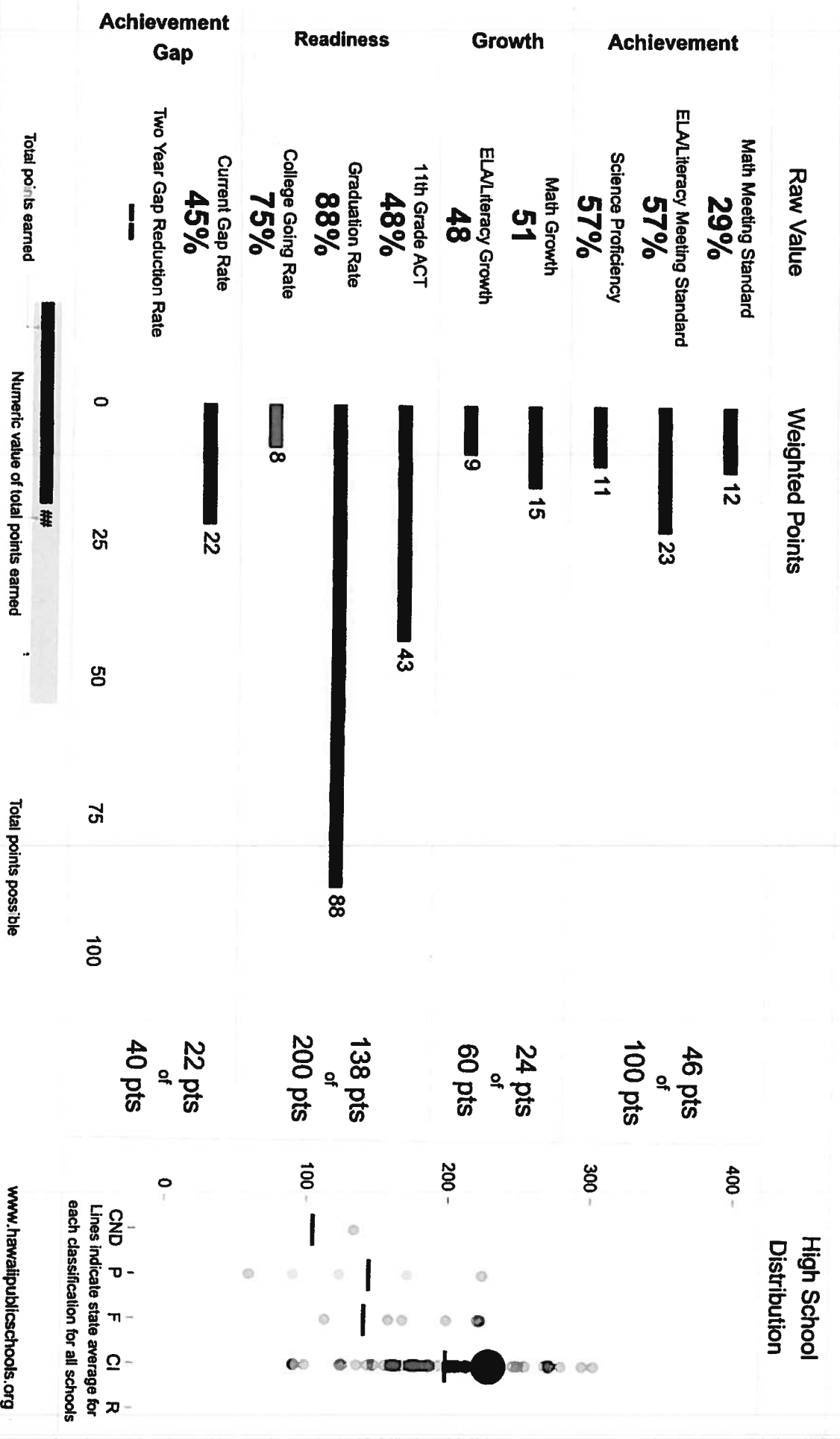

NOTE: Final display numbers are rounded, which may cause subtotals to appear to sum incorrectly. The total points value on the upper right is accurate.
 Run Date: Tuesday, September 22, 2015

312

Kalaheo High**Trend Report:
Educational and Fiscal Accountability****School Report for School Year 2014-2015**

A *Guide to Understanding Trend Reports* explains the educational and fiscal measures and lists schools in each of the complexes for the school year 2014-15. The *Guide* is available on-line at <http://arch.k12.hi.us>.

Background

Student Enrollment	Total	SPED		ELL		Free & Reduced-Cost Lunch Program		Kindergartners Who Attended Preschool
		#	%	#	%	#	%	
School Year	#	#	%	#	%	#	%	%
2012-2013	855	96	11.2%	11	1.2%	213	24.9%	na
2013-2014	908	116	12.7%	11	1.2%	242	26.6%	na
2014-2015	916	105	11.4%	*	*	214	23.3%	na

Teachers	Total	Licensed	Years Experience	5+ Years at This School	Classes Taught by Teachers Meeting NCLB Requirements	Advanced Degree	Early Childhood Endorsement (Gr. K teachers)
School Year	#	%	Average	%	%	%	#
2012-2013	48	91.6%	11.0	48%	80%	52.0%	na
2013-2014	49	97.9%	10.7	41%	85%	48.9%	na
2014-2015	54	94.4%	9.3	31%	77%	44.4%	na

Academic Achievement

HI Statewide Assessment Program	ELA % Meeting Standard by Grade Level								Math % Meeting Standard by Grade Level							
	3	4	5	6	7	8	10	11	3	4	5	6	7	8	10	11
School Year																
2012-2013	na	na	na	na	na	na	79.3	--	na	na	na	na	na	na	67.0	--
2013-2014	na	na	na	na	na	na	75.9	--	na	na	na	na	na	na	43.4	--
2014-2015	na	na	na	na	na	na	--	55.3	na	na	na	na	na	na	--	28.1

HI Statewide Assessment Program	Science % Proficient by Grade Level		
School Year	4	8	HS
2012-2013	na	na	61.7
2013-2014	na	na	49.7
2014-2015	na	na	57.6

School Year	Proportion Ready for Kindergarten	Retention Rate %			Dropout Rate % (4-year rate)	Graduate On-Time %	Others %
		Elementary	Middle	Grade 9			
2012-2013	na	na	na	8.6%	11.3%	84.9%	3.6%
2013-2014	na	na	na	8.2%	8.7%	87.4%	3.8%
2014-2015	na	na	na	2.7%	9.7%	88.2%	1.9%

*Results suppressed to protect student identity, in accordance with the Family Educational Rights and Privacy Act (FERPA)

Safety and Well-Being

Students	Average Daily Attendance %		Offenses by Type of Incident (number of citations per 1,000 students)					
			Violence		Property		Illicit Substances	
			Elementary	Secondary	Elementary	Secondary	Elementary	Secondary
School Year	Elementary	Secondary	Elementary	Secondary	Elementary	Secondary	Elementary	Secondary
2012-2013	na	91.5%	na	13	na	8	na	7
2013-2014	na	91.9%	na	28	na	7	na	11
2014-2015	na	93.0%	na	28	na	7	na	16

School	Persistently Dangerous Schools (NCLB)	Workers' Compensation Claims		Student and Teacher Perceptions on School Safety and Well-Being			
School Year	Yes/No	Total # of claims	% of claims resulting in loss-time	Safety % Positive Responses		Well-Being % Positive Responses	
				Students	Teachers	Students	Teachers
2012-2013	No	1	0.0%	--	--	--	--
2013-2014	No	1	0.0%	--	--	--	--
2014-2015	No	--	--	54.7%	55.3%	58.9%	57.5%

Civic Responsibility

	Young Voter Registration	Kids Voting Hawaii		Students Who Are Not Suspended	Volunteer Hours
School Year	# of students participating	# of students participating	% of students participating	% of Enrollment	# of PCNC volunteer hours per 100 students
2012-2013	--	799	93.4%	95.3%	--
2013-2014	--	--	--	94.9%	374
2014-2015	--	812	88.6%	94.1%	300

Fiscal Accountability

School Year	State General Funds				Explanation of Significant Budget Changes
	School Salaried Payroll	Allocation Excluding School Salaried Payroll	Expended	Carryover	
2012-2013	\$4,363,580	\$650,091	\$545,913	\$104,178	none
2013-2014	\$4,819,126	\$717,984	\$649,253	\$68,731	none
2014-2015	\$5,046,948	\$644,509	\$518,312	\$126,197	none



Kalaheo High School

School Code: 312

Grades 9-12

School Status and Improvement Report School Year 2014-15



Contents

Focus on Standards	p. 1
School Description	p. 1
School Setting	pp. 2-3
• Student Profile	
• Community Profile	
School Improvement	p. 4
• Summary of Progress	
School Resources	p. 5
• Certified Staff	
• Facilities	
Vital Signs	pp. 6-8
• School Quality Survey	
• Student Conduct	
• School Retention or Completion	
• Hawaii Statewide Assessment Program	
• Other School Information	

School Address:

Kalaheo High School
730 Iliaina Street
Kailua, Hawaii 96734

Focus On Standards

This School Status and Improvement Report has been prepared as part of the Department's education accountability system to provide regular, understandable accounts of our schools' performance and progress, as required by §302A-1004, Hawai'i Revised Statutes.

This report describes the school and its setting; provides information about the school's administrators, teachers, students and facilities; summarizes progress made based on the school's improvement plan; and reports student achievement results along with other vital signs.

School Description

Originally established in 1966 as an intermediate school, Kalaheo became a high school in 1973. It enjoys a reputation for high academic student achievement. The school's vision is a community of learners where individuals prepare for the challenges and opportunities in a diverse and global society. Its purpose is to prepare students for higher education, future employment, and responsible citizenship. The school curriculum offers a wide range of courses, including high level language arts, mathematics, social studies, and sciences through its Honors and Advanced Placement courses. The open enrollment policy for Honor and AP classes has increased the number of students who sign up for the rigorous course work. A new "hybrid" computer class was offered for the first time school year 2014-15. This class offers on-line learning options to students in a classroom equipped with new computers and a full-time teacher to facilitate students' success in completing on-line courses. The school's Naval Junior Reserve Officer Training Corps, or NJROTC, has distinguished itself with numerous awards, including being ranked number two out of all the units in the North Western Region of the United States. Kalāheo High School has a strong Communication Academy Pathway with its focus on digital media and broadcasting. In support of S.T.E.M (Science, Technology, Engineering, Math) during the 2009-10 school year, a robotics team was created as an extra-curricular club with students working after school and on weekends to complete their robotics project in order to compete with other schools in major events. Robotics is currently offered as a regular course of study for credit during the school year with students still working as a club to accommodate those whose schedules cannot accommodate the class during the school day. Kalaheo graduates serve as mentors for the current students.

At Kalāheo, there are four Career and Technical Education Pathways: Health Services, Arts and Communication Academy, Public Human Services, and Industrial and Engineering Technology. A new elective will begin in Fall 2015 - Natural Resources. These career pathways begin in ninth grade and continue into each following school year.

In June 2010, Kalaheo was awarded an accreditation period of six years by the Western Association of Schools and Colleges. A full accreditation visit is scheduled for the Spring of 2016. In 2015, Kalaheo High School was included in the top nine percent of high schools in the nation recognized by the Washington Post High School Challenge Index for effectively preparing students for college.

School Setting

Student Profile

School year	2012-13	2013-14	2014-15		2012-13	2013-14	2014-15
Fall enrollment	855	908	916	Number and percent of students in Special Education programs	96	116	105
					11.2%	12.7%	11.4%
Number and percent of students enrolled for the entire school year	778	827	819	Number and percent of students with limited English proficiency	11	11	*
	90.9%	91.0%	89.4%		1.2%	1.2%	*
Number and percent of students receiving free or reduced-cost lunch	213	242	214				
	24.9%	26.6%	23.3%				

Note: "--" means missing data.
 "*" means data not reported to maintain student confidentiality (see FERPA).

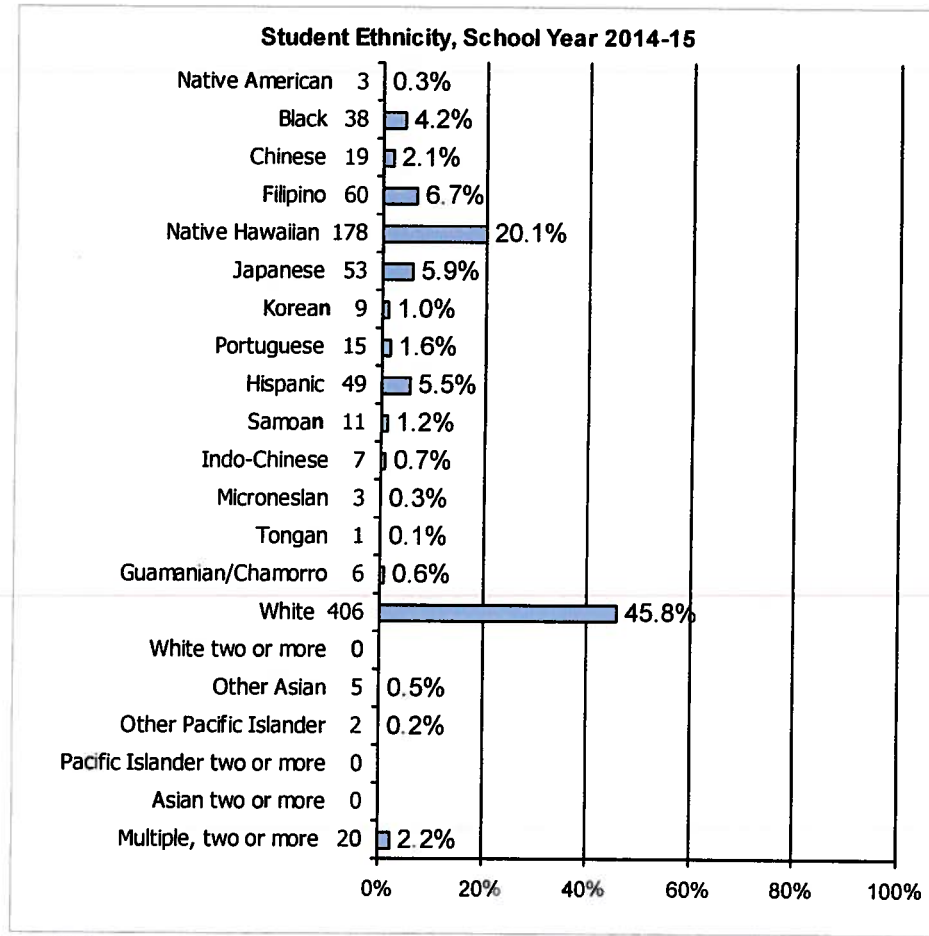

School Setting

Community Profile

The *Community Profile* information updated in this school report reflects selected 2010 demographics for the High School Complex (HSC) area in which this school resides. Profile data are based on the 2010 U.S. Census, the American Community Survey (ACS) 2006-2010 five-year estimates (centric to 2008), and the incorporation of Hawaii's HSC boundary areas with updated 2010 Census geography. Figures for educational attainment and median household income are sample estimates obtained from the ACS, adapted to conform to HSC geography, and should be considered rough approximations of census counts.

Based on the 2010 U.S. Census

Kalaheo HSC Complex	School Community	State of Hawai'i
Total population	34,449	1,360,301
Percentage of population aged 5-19	17.3%	18.4%
Median age of population	31.0	38.6
Number of family households	8,171	313,907
Median household income	\$79,267	\$66,420

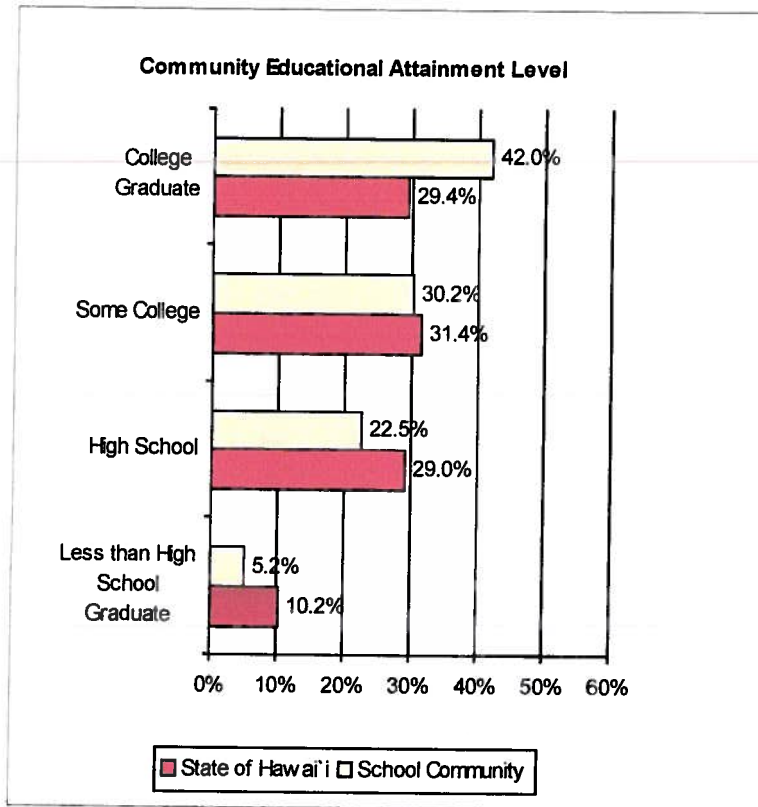

School Improvement

Summary of Progress

Kalaheo High School completed the fifth year of the Kailua-Kalaheo complex initiative focused on developing collaborative leadership in the schools and data-driven decision-making in the classrooms. Kalaheo complex schools embarked on an articulated K-12 writing initiative that will strengthen students' writing skills by using common keystone writing rubrics to evaluate evidence-based writing as students progress through the elementary grade levels to middle school and to high school.

Goal: Academic success for all students in every classroom.

Focus on standards and clear Learning Targets: Teachers at Kalāheo HS have developed and continue to use pacing guides in all content areas to deliver quality curriculum aligned to the Common Core Standards in Language Arts and Mathematics and the Hawaii Content Standards and national standards in other core and elective content areas. Increased collaboration amongst teachers who instruct the same content areas has resulted in better articulation across grade levels and the use of data teams to analyze the results of common course formative assessments. Quarterly summative assessment results in all courses were gathered as preliminary indicators of College and Career readiness.

Use data to inform instructional decisions: The teachers' desire for more authentic forms of assessment has brought about a growing trend among the core departments to develop, administer, and utilize common assessments. The implementation of this collaborative work informs instructional practice. This data is reviewed by staff members during regularly scheduled departmental collaboration times. Department chairs have developed additional common content collaboration that delves more specifically into revision and improvement of content emphases and improved instruction. The use of formative assessment practices and subsequent data review is ongoing.

Engage all students in the learning process: Teachers are implementing the Effective Cycle of Instruction as they plan and deliver standards-based lessons. The school's Academic Review Team (ART), comprised of department leaders, guided the continuous professional development efforts for the faculty. Teachers selected specific strategies, implemented them, collected data and analyzed the impact on student achievement through their department collaboration time. Focused Peer walkthroughs were encouraged to allow teachers to visit other teachers' classes and observe the instructional process and learning environment.

Challenges for school year 2014-15 included implementing the Effective Educator System, including the use of a teacher observation protocol from the Charlotte Danielson feedback model and implementing Student Learning Objectives. The Smarter Balanced Hawaii State Assessment results will create a new baseline for Kalaheo students moving forward into the 2015-16 school year. This new assessment preparation included utilizing targeted tutoring to build skills capacity in foundational Algebra I concepts and operations. This was the second year the state Department of Education implemented end-of-course (EOC) exams in Biology, U.S. History, Algebra 1 and Algebra 2, the results of which impacted the students' final course grades. Results were mixed - Biology and U.S. History results indicate students are learning the course objectives; Algebra 1 and Algebra 2 results indicate that teachers will need to tighten their pacing of course content and implement instructional strategies and interventions to support the learning of all students.

School Resources

Certified Staff

Teaching Staff

Total Full-Time Equivalent (FTE)		53.5
Regular Instruction, FTE	77.5%	41.5
Special Instruction, FTE	20.5%	11.0
Supplemental Instruction, FTE	1.8%	1.0
Teacher headcount		54
Teachers with 5 or more years at this school		17
Teachers' average years of experience		9.3
Teachers with advanced degrees		24

Professional Teacher Credentials

Fully licensed	94.4%	51
Emergency hires	5.5%	3

Students per Teaching Staff*

Regular Instruction	19.5
Special Instruction	9.5

* Regular instruction includes both regular and supplemental teaching staff. Therefore, these figures do not indicate class size.

Administrative and Student Services Staff

Administration, FTE *	8.0
Librarians, FTE	1.0
Counselors, FTE	4.0
Number of principals at this school in the last five years	1

* Administration includes Principals, Vice-Principals, Student Activity Coordinators, Student Services Coordinators, Registrars, and Athletic Directors

Facilities

School Year Ending 2015

Classrooms available	60
Number of classrooms short (-) or over (+)	2

School facilities inspection results

From the 2011 school year, school facilities inspection data are no longer available at the state level. Department schools are still required to do an annual assessment of its facilities in the following areas: Grounds, Building exterior, Building interior, Equipment/Furnishings, Health/Safety and Sanitation. All department schools should have their annual inspections completed by the second quarter of the school year.

Historically, the majority of the department schools attained inspection assessment points in the following ranges: 9-15, earning a "Satisfactory" rating, and 16-18 points, earning the highest "Very Good" rating.

Note. " -- " means missing data.

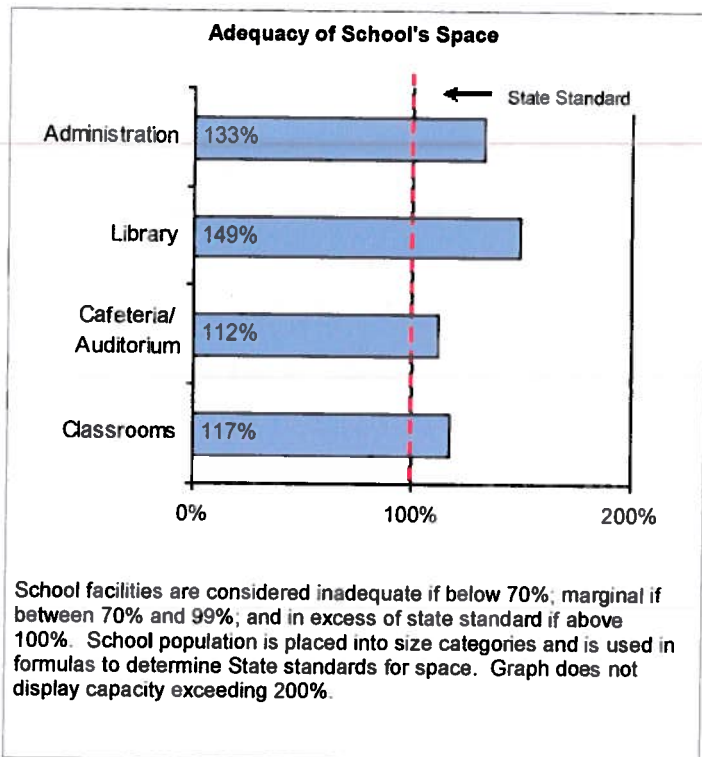

Vital Signs

School Quality Survey

The School Quality Survey (SQS), administered periodically by the Accountability Section, is used for strategic planning and to comply with state accountability requirements.

Percent of Positive Responses

School Quality Survey [*]		Teachers		Parents		Students	
		School	State	School	State	School	State
Safety	2014	--	--	--	--	--	--
	2015	55.3%	76.0%	69.6%	74.3%	54.7%	69.4%
Well-Being	2014	--	--	--	--	--	--
	2015	57.5%	75.0%	80.4%	81.6%	58.9%	64.4%
Satisfaction	2014	--	--	--	--	--	--
	2015	39.6%	60.2%	61.8%	71.5%	49.9%	69.7%
Involvement/Engagement	2014	--	--	--	--	--	--
	2015	44.4%	70.4%	61.5%	69.3%	43.2%	58.2%

Survey Return Rate ^{**}		Teachers		Parents		Students	
		School	State	School	State	School	State
	2014	--	--	--	--	--	--
	2015	92.9%	83.4%	16.2%	15.7%	77.6%	70.8%

* The SQS is completed by students and parents of students in grades 4, 5, 7, 8, 9, and 11 and by all teachers of the school. State Teacher and Parent positive response figures are one of four grade spans (Gr. K to 5/6, Gr. 6/7 to 8, Gr. 9 to 12, and Multi-level) that best correspond to this school's grade span. The Student positive response figures for the State and this school are those of the highest grade level surveyed at this school.

** State Return Rate for Teachers, Parents, and Students are for one of six grade spans (Elementary, Elementary/Middle, Elementary/Middle/High, Middle, Middle/High, High) that corresponds to this school.

Note: In 2015, a revised School Quality Survey (SQS) was administered statewide to students, school staff, and parents. The dimensions, questions, and rating scale differ from the SQS administered in previous years; thus, the 2014 SQS percentages are intentionally left blank (--).

Vital Signs

Student Conduct

Attendance and Absences

School Year			State Standard
2012-13	2013-14	2014-15	
Average Daily Attendance: % (higher is better)			
91.5%	91.9%	93.0%	95.0%
Average Daily Absences: in days (lower is better)			
15.2	14.4	12.5	9

Suspensions, School Year 2014-2015

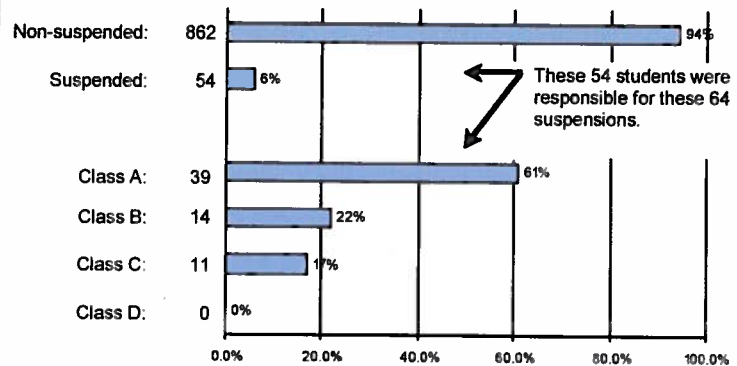

Examples of class of suspension:

- Class A: Burglary, robbery, sale of dangerous drugs
- Class B: Disorderly conduct, trespassing
- Class C: Class cutting, insubordination, smoking
- Class D: Contraband (e.g. possession of tobacco)

School Completion

School Dropouts

School Year	Number	Percent
2012-13	22	11.3%
2013-14	16	8.6%
2014-15	20	9.7%

The dropout figures are based on the cohort of first-time 9th graders who dropped out prior to graduating.

Graduates and Other Completers

	2012-13	2013-14	2014-15
Total number of Seniors	173	179	195
Percent of Diploma graduates	98.2%	98.8%	97.4%
Percent of Certificate of Course Completion	0.0%	0.0%	0.0%
Percent of Individually Prescribed Program	1.1%	0.0%	0.0%
Percent of school completers	99.4%	98.8%	97.4%

Total number of Freshmen	164	161	181
Percent graduated on time	84.9%	87.5%	88.2%

Freshmen who began high school in School Year 2011-12 and graduated in 2014-15.

Note. " - " means missing data.
 " * " means data not reported to maintain student confidentiality (see FERPA)

Vital Signs

Hawaii Statewide Assessment Program

Hawaii Common Core Standards
English Language Arts/Literacy

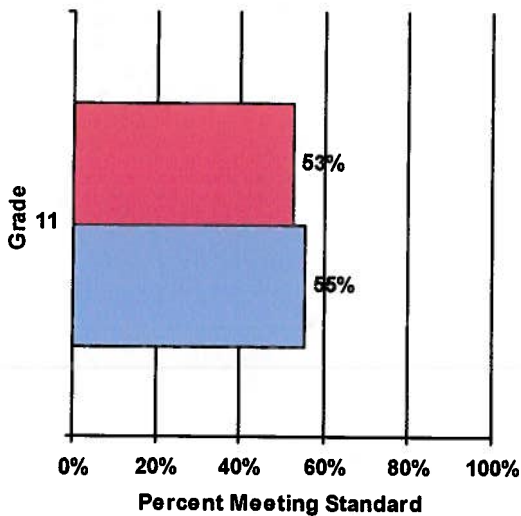

Hawaii Common Core Standards
Mathematics

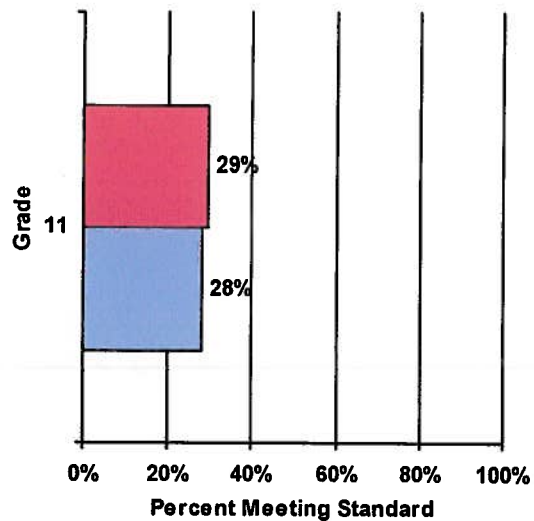

HCPS Science

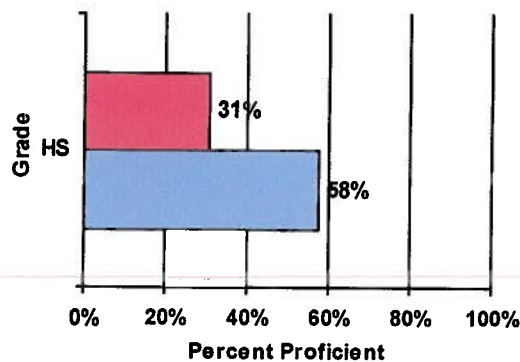

The HCPS Science assessment is given in grades 4 and 8. High School (HS) HCPS Science assessment results are from an end-of-course exam given to high school students enrolled in Biology I.



A school's bar may not be shown to maintain student confidentiality (see FERPA).

Other School Information

Kalaheo High School was accredited by the Western Association of Schools and Colleges for a period of six years with a mid-term review. This school's accreditation status expires in 2016.

Published on November 24, 2015.

Accountability Section, Assessment and Accountability Branch, Office of Strategy, Innovation and Performance, Honolulu, HI: Hawaii State Department of Education.

School Quality Survey

Kalaheo High

Spring 2015

Hawaii Department of Education
Office of Strategy, Innovation, and Performance
Assessment and Accountability Branch
Accountability Section

Publication Date: October 2015

School survey size and return rate:

Group	# Distributed	# Returned	Return Rate (%)
Students:	469	364	77.6%
Parents	469	76	16.2%
Teachers:	57	53	92.9%

SQS Summary Table

Dimension	Group		Percent (%) Response			
			Average (7-1)	Positive (> 4.0)	Neutral (= 4.0)	Negative (< 4.0)
A. Safety	Students	9th, 11th grades	4.6	54.7%	27.1%	18%
	Parents		5.0	69.6%	19.4%	10.9%
	Teachers		4.5	55.3%	18%	26.5%
B. Well-Being	Students	9th, 11th grades	4.7	58.9%	21.8%	19.1%
	Parents		5.4	80.4%	13.9%	5.6%
	Teachers		4.5	57.5%	16%	26.4%
C. Satisfaction	Students	9th, 11th grades	4.4	49.9%	31.5%	18.4%
	Parents		4.6	61.8%	16.8%	21.2%
	Teachers		4.0	39.6%	21.1%	39.2%
D. Involvement/Engagement	Students	9th, 11th grades	4.2	43.2%	32.9%	23.8%
	Parents		4.7	61.5%	23.9%	14.5%
	Teachers		4.1	44.4%	21.2%	34.2%

SQS Summary Figure

Dimension	Group	Percent Positive Response
-----------	-------	---------------------------

A. Safety

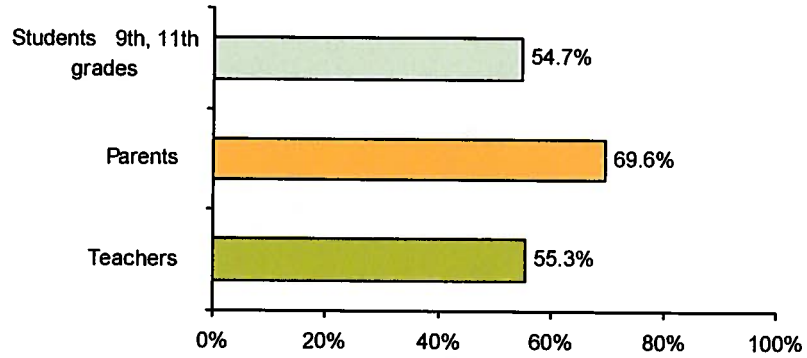

B. Well-Being

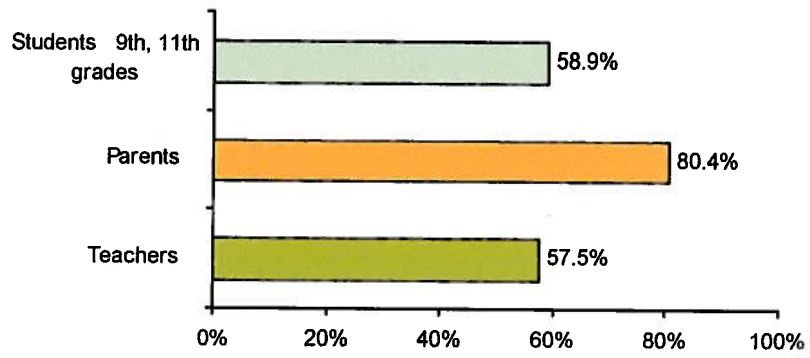

C. Satisfaction

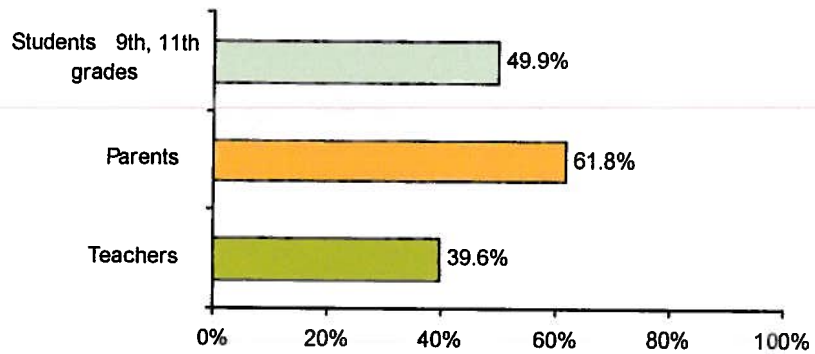

D. Involvement/Engagement

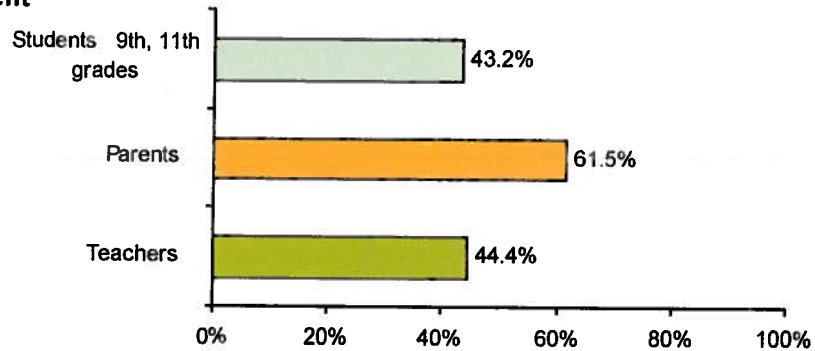

High School Student Survey

A. Safety

	Completely Agree (7)	Strongly Agree (6)	Agree (5)	Neutral (4)	Disagree (3)	Strongly Disagree (2)	Completely Disagree (1)	N	Average Rating
1. I feel safe at school.	74 20.4%	44 12.2%	106 29.3%	88 24.3%	26 7.2%	10 2.8%	14 3.9%	362 100%	4.9
2. Students at my school who violate safety rules are disciplined.	33 9.1%	37 10.2%	106 29.2%	100 27.5%	39 10.7%	21 5.8%	27 7.4%	363 100%	4.3
3. I feel safe from the bullying behavior of students at my school.	62 17.1%	60 16.6%	87 24.0%	89 24.6%	32 8.8%	17 4.7%	15 4.1%	362 100%	4.8
4. I feel the school grounds and facilities are safe for students.	40 11.1%	37 10.2%	100 27.7%	116 32.1%	39 10.8%	13 3.6%	16 4.4%	361 100%	4.5
5. If I ever got sick at school, someone would take care of me.	46 12.7%	37 10.2%	104 28.8%	102 28.3%	34 9.4%	10 2.8%	28 7.8%	361 100%	4.5
6. There are clear rules to ensure students' safety at school.	33 9.2%	52 14.6%	127 35.6%	94 26.3%	27 7.6%	12 3.4%	12 3.4%	357 100%	4.7
Dimension Totals:	288 13.3%	267 12.3%	630 29.1%	589 27.2%	197 9.1%	83 3.8%	112 5.2%	2,166 100%	4.6

B. Well-Being

	Completely Agree (7)	Strongly Agree (6)	Agree (5)	Neutral (4)	Disagree (3)	Strongly Disagree (2)	Completely Disagree (1)	N	Average Rating
7. I have friends at school who care about me.	135 37.3%	71 19.6%	100 27.6%	36 9.9%	7 1.9%	1 0.3%	12 3.3%	362 100%	5.7
8. My teachers give me help on classwork when I need it.	58 16.2%	70 19.5%	128 35.7%	66 18.4%	13 3.6%	11 3.1%	13 3.6%	359 100%	5.0
9. If I feel bad, I can get help from the school staff.	32 8.9%	45 12.5%	103 28.6%	106 29.4%	38 10.6%	16 4.4%	20 5.6%	360 100%	4.4
10. I usually get a good night's sleep before going to school in the morning.	34 9.4%	30 8.3%	80 22.2%	105 29.2%	58 16.1%	26 7.2%	27 7.5%	360 100%	4.1
11. I usually eat breakfast before school.	77 21.3%	26 7.2%	78 21.6%	70 19.4%	51 14.1%	20 5.5%	39 10.8%	361 100%	4.4
12. I am treated fairly at this school.	38 10.6%	52 14.5%	117 32.7%	90 25.1%	29 8.1%	16 4.5%	16 4.5%	358 100%	4.6
Dimension Totals:	374 17.3%	294 13.6%	606 28.1%	473 21.9%	196 9.1%	90 4.2%	127 5.9%	2,160 100%	4.7

High School Student Survey

C. Satisfaction

	Completely Agree (7)	Strongly Agree (6)	Agree (5)	Neutral (4)	Disagree (3)	Strongly Disagree (2)	Completely Disagree (1)	N	Average Rating
13. I feel my classes are preparing me well for more schooling or for a job.	23 6.4%	46 12.8%	93 25.9%	115 32.0%	44 12.3%	17 4.7%	21 5.8%	359 100%	4.3
14. I am satisfied with the education I am receiving at my school.	31 8.6%	43 11.9%	98 27.2%	121 33.6%	34 9.4%	14 3.9%	19 5.3%	360 100%	4.4
15. My school's facilities help me learn.	26 7.3%	43 12.1%	113 31.7%	123 34.6%	23 6.5%	11 3.1%	17 4.8%	356 100%	4.5
16. I am satisfied with the quality of teaching most of my teachers provide at school.	31 8.7%	57 15.9%	107 29.9%	92 25.7%	35 9.8%	16 4.5%	20 5.6%	358 100%	4.5
17. Overall, this is a good school.	39 10.9%	40 11.2%	105 29.3%	114 31.8%	22 6.1%	11 3.1%	27 7.5%	358 100%	4.5
Dimension	150	229	516	565	158	69	104	1,791	
Totals:	8.4%	12.8%	28.8%	31.5%	8.8%	3.9%	5.8%	100%	4.5

D. Involvement/Engagement

	Completely Agree (7)	Strongly Agree (6)	Agree (5)	Neutral (4)	Disagree (3)	Strongly Disagree (2)	Completely Disagree (1)	N	Average Rating
18. If I have concerns, I feel comfortable speaking to school staff about them.	34 9.4%	32 8.9%	87 24.2%	111 30.8%	53 14.7%	17 4.7%	26 7.2%	360 100%	4.2
19. I like coming to school.	28 7.9%	26 7.3%	81 22.8%	110 30.9%	46 12.9%	19 5.3%	46 12.9%	356 100%	4.0
20. When there is a school event that I like, I participate.	25 7.0%	34 9.5%	86 24.0%	128 35.7%	40 11.1%	16 4.5%	30 8.4%	359 100%	4.2
21. I am interested in classes and programs provided at school.	35 9.7%	42 11.6%	111 30.7%	124 34.3%	23 6.4%	7 1.9%	19 5.3%	361 100%	4.6
Dimension	122	134	365	473	162	59	121	1,436	
Totals:	8.5%	9.3%	25.4%	32.9%	11.3%	4.1%	8.4%	100%	4.2

A. Safety

	Completely Agree (7)	Strongly Agree (6)	Agree (5)	Neutral (4)	Disagree (3)	Strongly Disagree (2)	Completely Disagree (1)	N	Average Rating
1. My child is safe at school.	17 22.4%	18 23.7%	25 32.9%	12 15.8%	3 3.9%	0 0.0%	1 1.3%	76 100%	5.4
2. My child is safe from harassment, intimidation, and threats at school.	12 15.8%	13 17.1%	28 36.8%	9 11.8%	10 13.2%	1 1.3%	3 3.9%	76 100%	4.9
3. My child has a caring adult to ensure my child's safety at school.	13 17.6%	15 20.3%	23 31.1%	18 24.3%	4 5.4%	0 0.0%	1 1.4%	74 100%	5.1
4. The school grounds and facilities are safe for my child.	10 13.3%	14 18.7%	29 38.7%	16 21.3%	5 6.7%	0 0.0%	1 1.3%	75 100%	5.1
5. Threats, intimidation, harassment, or hazing are rare in this school.	6 8.1%	14 18.9%	15 20.3%	22 29.7%	7 9.5%	7 9.5%	3 4.1%	74 100%	4.4
6. My child's school has clear rules to maintain students' safety at school.	13 17.8%	12 16.4%	35 47.9%	10 13.7%	1 1.4%	0 0.0%	2 2.7%	73 100%	5.2
Dimension Totals:	71 15.8%	86 19.2%	155 34.6%	87 19.4%	30 6.7%	8 1.8%	11 2.5%	448 100%	5.0

B. Well-Being

	Completely Agree (7)	Strongly Agree (6)	Agree (5)	Neutral (4)	Disagree (3)	Strongly Disagree (2)	Completely Disagree (1)	N	Average Rating
7. My child has friends in school who care about my child.	27 37.0%	18 24.7%	21 28.8%	7 9.6%	0 0.0%	0 0.0%	0 0.0%	73 100%	5.9
8. My child's teachers provide help on classwork when my child needs it.	15 20.0%	21 28.0%	18 24.0%	13 17.3%	7 9.3%	0 0.0%	1 1.3%	75 100%	5.3
9. If my child ever got sick at school, someone would take care of my child.	11 14.9%	20 27.0%	26 35.1%	14 18.9%	2 2.7%	0 0.0%	1 1.4%	74 100%	5.3
10. My child is well-rested for school.	20 26.7%	20 26.7%	27 36.0%	6 8.0%	1 1.3%	1 1.3%	0 0.0%	75 100%	5.7
11. My child is fed before school.	38 50.7%	8 10.7%	20 26.7%	9 12.0%	0 0.0%	0 0.0%	0 0.0%	75 100%	6.0
12. Students are treated fairly at school.	10 13.5%	10 13.5%	29 39.2%	13 17.6%	6 8.1%	4 5.4%	2 2.7%	74 100%	4.8
Dimension Totals:	121 27.1%	97 21.7%	141 31.6%	62 13.9%	16 3.6%	5 1.1%	4 0.9%	446 100%	5.5

C. Satisfaction

	Completely Agree (7)	Strongly Agree (6)	Agree (5)	Neutral (4)	Disagree (3)	Strongly Disagree (2)	Completely Disagree (1)	N	Average Rating
13. I am satisfied with the education my child is receiving at school.	7 9.3%	12 16.0%	33 44.0%	9 12.0%	8 10.7%	3 4.0%	3 4.0%	75 100%	4.7
14. I am satisfied with the quality of resources the DOE provides to teachers and students for learning.	7 9.6%	6 8.2%	23 31.5%	14 19.2%	13 17.8%	6 8.2%	4 5.5%	73 100%	4.3
15. I am satisfied with the printed materials, e-mail/online, phone/text, or in-person meetings used by the school to communicate with me.	11 14.9%	10 13.5%	28 37.8%	11 14.9%	8 10.8%	3 4.1%	3 4.1%	74 100%	4.8
16. My child's teachers seek ways to improve my child's academic progress.	7 9.5%	16 21.6%	23 31.1%	16 21.6%	6 8.1%	4 5.4%	2 2.7%	74 100%	4.8
Dimension Totals:	32 10.8%	44 14.9%	107 36.1%	50 16.9%	35 11.8%	16 5.4%	12 4.1%	296 100%	4.6

D. Involvement/Engagement

	Completely Agree (7)	Strongly Agree (6)	Agree (5)	Neutral (4)	Disagree (3)	Strongly Disagree (2)	Completely Disagree (1)	N	Average Rating
17. Teachers are available to discuss my child's work or behavior.	11 14.7%	15 20.0%	24 32.0%	15 20.0%	5 6.7%	0 0.0%	5 6.7%	75 100%	4.9
18. If I have concerns, I am taken seriously by school administrators.	8 10.7%	11 14.7%	22 29.3%	23 30.7%	6 8.0%	1 1.3%	4 5.3%	75 100%	4.6
19. The school staff makes me feel welcome at the school.	9 12.0%	15 20.0%	28 37.3%	15 20.0%	4 5.3%	2 2.7%	2 2.7%	75 100%	4.9
20. The school gives me opportunities to participate in important decisions about my child's education.	7 9.6%	12 16.4%	31 42.5%	14 19.2%	6 8.2%	1 1.4%	2 2.7%	73 100%	4.8
21. Most of my child's teachers work with me to improve my child's learning	9 12.2%	9 12.2%	24 32.4%	21 28.4%	7 9.5%	2 2.7%	2 2.7%	74 100%	4.7
22. The school has encouraged me to participate in classroom and school activities.	8 10.7%	12 16.0%	20 26.7%	19 25.3%	10 13.3%	3 4.0%	3 4.0%	75 100%	4.6
Dimension Totals:	52 11.6%	74 16.6%	149 33.3%	107 23.9%	38 8.5%	9 2.0%	18 4.0%	447 100%	4.8

Teacher Survey

A. Safety

	Completely Agree (7)	Strongly Agree (6)	Agree (5)	Neutral (4)	Disagree (3)	Strongly Disagree (2)	Completely Disagree (1)	N	Average Rating
1. I feel safe at school.	12 23.1%	15 28.8%	8 15.4%	8 15.4%	5 9.6%	1 1.9%	3 5.8%	52 100%	5.1
2. The school effectively handles staff discipline problems.	5 9.6%	6 11.5%	6 11.5%	13 25.0%	11 21.2%	4 7.7%	7 13.5%	52 100%	3.9
3. I feel safe from harassment, intimidation, and threats at school.	9 17.0%	9 17.0%	14 26.4%	6 11.3%	8 15.1%	2 3.8%	5 9.4%	53 100%	4.6
4. I feel the grounds and facilities at school are safe for staff.	9 17.0%	7 13.2%	15 28.3%	13 24.5%	6 11.3%	0 0.0%	3 5.7%	53 100%	4.8
5. The established safety policies at school make me feel safe.	9 17.0%	6 11.3%	15 28.3%	9 17.0%	7 13.2%	4 7.5%	3 5.7%	53 100%	4.6
6. My school has clear rules for staff behavior.	8 15.1%	7 13.2%	15 28.3%	8 15.1%	8 15.1%	3 5.7%	4 7.5%	53 100%	4.5
Dimension Totals:	52 16.5%	50 15.8%	73 23.1%	57 18.0%	45 14.2%	14 4.4%	25 7.9%	316 100%	4.6

B. Well-Being

	Completely Agree (7)	Strongly Agree (6)	Agree (5)	Neutral (4)	Disagree (3)	Strongly Disagree (2)	Completely Disagree (1)	N	Average Rating
7. I have colleagues at school who care about me.	13 24.5%	12 22.6%	22 41.5%	5 9.4%	0 0.0%	0 0.0%	1 1.9%	53 100%	5.5
8. My leadership provides me with effective advice when I have problems on the job.	6 11.3%	5 9.4%	17 32.1%	11 20.8%	6 11.3%	2 3.8%	6 11.3%	53 100%	4.3
9. My school provides me with the support I need to do my job well.	5 9.4%	4 7.5%	15 28.3%	7 13.2%	12 22.6%	6 11.3%	4 7.5%	53 100%	4.0
10. I feel staff are treated fairly at school.	6 11.3%	3 5.7%	14 26.4%	11 20.8%	11 20.8%	2 3.8%	6 11.3%	53 100%	4.1
Dimension Totals:	30 14.2%	24 11.3%	68 32.1%	34 16.0%	29 13.7%	10 4.7%	17 8.0%	212 100%	4.5

C. Satisfaction

	Completely Agree (7)	Strongly Agree (6)	Agree (5)	Neutral (4)	Disagree (3)	Strongly Disagree (2)	Completely Disagree (1)	N	Average Rating
11. I enjoy working at my school.	7 13.7%	9 17.6%	16 31.4%	13 25.5%	3 5.9%	1 2.0%	2 3.9%	51 100%	4.9
12. I am satisfied with the quality of resources the DOE provides to teachers and students for learning.	4 7.5%	3 5.7%	6 11.3%	6 11.3%	13 24.5%	13 24.5%	8 15.1%	53 100%	3.3
13. I am satisfied with the professional development opportunities the DOE provides for me.	5 9.8%	4 7.8%	9 17.6%	12 23.5%	10 19.6%	6 11.8%	5 9.8%	51 100%	3.9
14. I am satisfied with the respect and value my school gives to my role.	7 13.5%	5 9.6%	12 23.1%	8 15.4%	10 19.2%	6 11.5%	4 7.7%	52 100%	4.2
15. I am satisfied with the opportunities I have to contribute to policy decisions that affect my school.	5 9.4%	5 9.4%	6 11.3%	16 30.2%	11 20.8%	4 7.5%	6 11.3%	53 100%	3.9
Dimension Totals:	28 10.8%	26 10.0%	49 18.8%	55 21.2%	47 18.1%	30 11.5%	25 9.6%	260 100%	4.0

D. Involvement/Engagement

	Completely Agree (7)	Strongly Agree (6)	Agree (5)	Neutral (4)	Disagree (3)	Strongly Disagree (2)	Completely Disagree (1)	N	Average Rating
16. If I have concerns, my leadership responds in a timely manner.	5 9.4%	2 3.8%	15 28.3%	10 18.9%	10 18.9%	5 9.4%	6 11.3%	53 100%	3.9
17. I am proud of the events, meetings, or programs my school provides.	5 9.4%	5 9.4%	16 30.2%	14 26.4%	9 17.0%	2 3.8%	2 3.8%	53 100%	4.4
18. For teachers/staff, I feel comfortable speaking to my school administrator; for principals, I feel comfortable speaking to my Complex Area Superintendent.	6 11.8%	5 9.8%	8 15.7%	8 15.7%	12 23.5%	4 7.8%	8 15.7%	51 100%	3.8
19. I can offer my opinions freely on ways to make improvements at my school.	4 7.5%	5 9.4%	11 20.8%	14 26.4%	10 18.9%	5 9.4%	4 7.5%	53 100%	4.0
20. I feel I am an integral, vital part of the educational community in which I work.	8 15.1%	4 7.5%	18 34.0%	10 18.9%	8 15.1%	2 3.8%	3 5.7%	53 100%	4.5
Dimension Totals:	28 10.6%	21 8.0%	68 25.9%	56 21.3%	49 18.6%	18 6.8%	23 8.7%	263 100%	4.2

AP Five-Year School Score Summary (2015)

This report shows five years of data at the school, state and global levels. On the first page, a graph illustrates the year-over-year change in the percentage of AP students with scores of 3 or higher. Next to a table that provides the overall total exams, total unique students and both the number and percentage of AP students with one or more scores of 3 or higher. On subsequent pages, the report provides subject-specific summary data by year: total exams, total exams by score and mean score.

✓ Data Updated Oct 1, 2015. Report Run Nov 9, 2015

Kalaheo High School (120143)

% of Total AP Students with Scores 3+

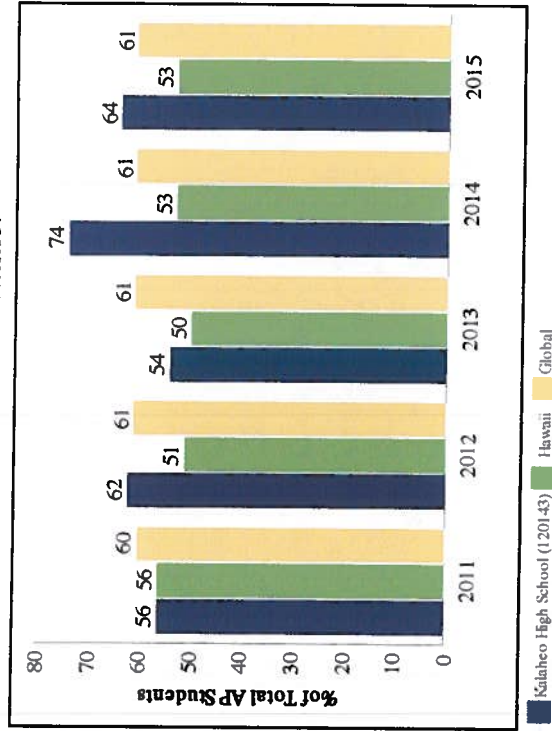

	2011	2012	2013	2014	2015
Kalaheo High School (120143)					
Total AP Students	118	143	134	143	166
Number of Exams	203	210	195	211	251
AP Students with Scores 3+	66	89	72	106	106
% of Total AP Students with Scores 3+	55.9	62.2	53.7	74.1	63.9
Hawaii					
Total AP Students	6,537	7,037	7,446	7,498	8,271
Number of Exams	10,306	10,940	11,436	11,702	13,168
AP Students with Scores 3+	3,637	3,611	3,720	4,001	4,356
% of Total AP Students with Scores 3+	55.6	51.3	50.0	53.4	52.7
Global					
Total AP Students	1,982,133	2,106,843	2,225,625	2,352,026	2,486,370
Number of Exams	3,475,395	3,714,079	3,955,410	4,199,454	4,498,991
AP Students with Scores 3+	1,193,662	1,295,051	1,354,800	1,442,136	1,509,831
% of Total AP Students with Scores 3+	60.2	61.5	60.9	61.3	60.7

"Success" on an AP Exam is defined as an exam score of 3 or higher, which represents the score point that research finds predictive of college success and college graduation. These findings have held consistent across the decades. One example of such a study comes from the National Center for Educational Accountability, which found that an AP Exam score, and a score of 3 or higher in particular, is a strong predictor of a student's ability to persist in college and earn a bachelor's degree.

The data in this report differs from other College Board reports, such as *The AP Report to the Nation*, which tracks exams taken by seniors throughout their high school career (senior-based) and includes public school data only.

© 2015 The College Board. College Board, AP, Advanced Placement, Advanced Placement Program, and the acorn logo are registered trademarks of the College Board.



7C Summary

Fall '14

Kalaheo High

Level: Secondary High

Responses: 1143

7C score

56%

Care

"Your success and well-being really matter to me in a serious way."

55%

Challenge

"I insist upon rigor—understanding, not just memorization—and your best effort."

63%

Control

"Our class is orderly, on task and respectful, with learning as our first priority."

57%

Clarify

"I have multiple good explanations; when you are confused I will help you understand."

59%

Captivate

"I make lessons intellectually relevant and stimulating because they are important."

54%

Confer

"You must talk with me to help me understand your ideas and support your learning."

49%

Consolidate

"I summarize lessons and check for understanding to make learning coherent."

57%

Kalaheo High School

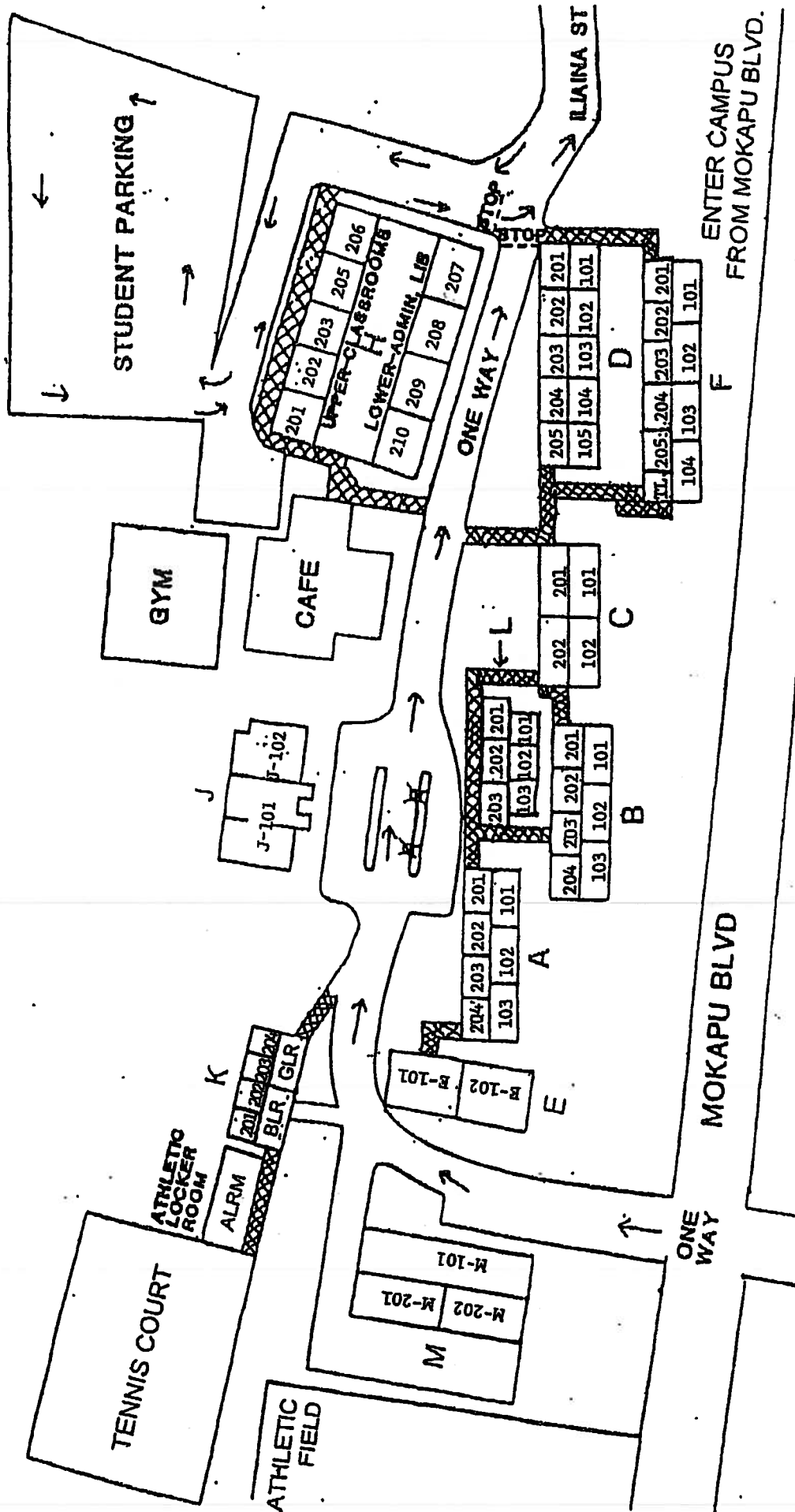

ENTER CAMPUS FROM MOKAPU BLVD.

WALKWAY

BUS STOP

SY 15-16 FIVE DAY BELL SCHEDULE

Revised 6/23/15

	5A	5B	5C	5D	5E
8:00-8:55	1	7	5	4	2
9:00-9:55	2	1	6	5	3
9:55-10:10	RECESS	RECESS	RECESS	RECESS	RECESS
10:15-11:15	3	2	7	6	4
11:20-12:15	4	3	1	7	5
12:15-12:45	LUNCH	LUNCH	LUNCH	LUNCH	LUNCH
12:50-1:45	5	4	2	1	6
1:50-2:45	6	MEETING: 1:55-2:55	3	MEETING: 1:55-2:55	7
2:45-2:55	ACTION				

Kalaheo High School Calendar
August 2015

~ August 2015 ~						
Sun	Mon	Tue	Wed	Thu	Fri	Sat
FINAL – 7/21/15	WASC – Accreditation Mtg. Home Group = Dept. Focus Group = Mixed	ART – Academic Review Team (DHs) – after school on Mon.				1
2 Event Schedule	3 1-5	4 6-2 EXT. Faculty Mtg. (1:55-3:55 pm) – WASC Overview Fall Athletic Night at 6:30 pm	5 3, P, 4, 5, 6 PTP Day	6 7-3 WASC Home Group Mtg. (1:55-2:55 pm)	7 4, 5, E, 6, 7 Welcome Back Assembly	8
9 5-Day Schedule	10 1-6	11 7-4 OLT Mtg. (1:55-2:55 pm) Open House at 6:30 pm	12 5-3	13 4-1 WASC Home Group Mtg. (1:55-2:55 pm)	14 2-7 New Teachers at Student Growth and Learning	15
16 4-Day Schedule	17 1-6	18 7-4 Yearbook Picture Taking Dept. Ops. Mtg. (1:55-2:55 pm) NJROTC Open House	19 5, 6, P, 7, 1, 2 PTP Day Yearbook Picture Taking	20 3-7 EXT. Faculty Mtg. (1:55-3:55 pm) -WASC Focus Group	21 HOLIDAY	22
23 5-Day Schedule	24 1-6	25 7-4 ILT Complex Faculty Mtg. (1:55-2:55 pm) - Google	26 5-3	27 4-1 Faculty Mtg. (1:55-2:55 pm) – RTI Class of 2016 College Night at 6:30 pm	28 2-7 New Teachers at Teacher Practice	29
30 5-Day Schedule	31 1-6	Notes:				

Kalaheo High School Calendar
September 2015

~ September 2015 ~						
Sun	Mon	Tue	Wed	Thu	Fri	Sat
FINAL – 7/21/15	Data Team – Dept. partner based on course Conference Day – you must attend a mtg. if requested	1 7-4 Data Team Mtg. (1:55-2:55 pm) – Common course & Pacing Guides	2 5-3 Qtr. 1 Interims Due by 3 pm	3 4-1 Faculty Mtg. (1:55-2:55 pm) on Instruction Share Out	4 2-7 NJROTC Training at MCBH	5 NJROTC Training at MCBH
6 4-Day Schedule	7 HOLIDAY – LABOR DAY	8 1-6	9 7-4 Faculty Mtg. (1:55-2:55 pm) -Google	10 5, 6, P, 7, 1, 2 PTP Day	11 3-7 Conference Day (1:55-2:55 pm)	12 Homecoming Dance
13 Event Schedule Homecoming Building Decorating	14 1-5	15 6-2 OLT Mtg. (1:55-2:55 pm)	16 3, P, 4, 5, 6 PTP Day	17 7-3 Dept. Ops. Mtg. (1:55-2:55 pm)	18 4, 5, E, 6, 7 Homecoming Assembly	19
20 5-Day Schedule	21 1-6	22 7-4 EXT. Faculty Mtg. (1:55-3:55 pm) – WASC Focus Group	23 5-3 ASVAB Test in library	24 4-1 WASC Home Group Mtg. (1:55-2:55 pm)	25 2-7	26
27 5-Day Schedule	28 1-6	29 7-4 Faculty Mtg.(1:55-2:55 pm) – Update on Pacing Guides & Qtr. 2 Inst. Strategies	30 5-3	Notes: OLT Mtg. – Operational Leadership Team (DHs) Dept. Ops. Mtg. – Dept. Operational Mtg.		



Kalaheo High School Calendar
October 2015

~ October 2015 ~						
Sun	Mon	Tue	Wed	Thu	Fri	Sat
FINAL - 7/21/15	Conference Day – you must attend a mtg. if requested			1 4-1 Conference Day (1:55-2:55 pm)	2 2-7 End of Qtr. 1	3
4	5 	6	7	8	9	10
11 4-Day Schedule	12 Teachers' Institute Day – no students	13	14 PSAT/NMSQT Exam	15 Qtr. 1 Grades Due at 8 am	16	17
18	19	20	21	22	23	24 Make a Difference Day
25	26	27 ILT Guided Visit at Kalaheo	28	29	30	31

Kalaheo High School Calendar
November 2015

~ November 2015 ~						
Sun	Mon	Tue	Wed	Thu	Fri	Sat
1 5-Day Schedule	2 1-6	3 7-4 Dept. Mtg.(1:55-2:55) -Ops	4 5-3	5 4-1 EXT. Faculty Mtg (1:55-3:55) – WASC Home groups	6 2-7	7
8 4-Day Schedule	9 1-6	10 7-4 EXT. Faculty Mtg (1:55-3:55) – ELL/RTI	11 HOLIDAY – No School	12 5, 6, P, 7, 1, 2 PTP Day	13 3-7	14 Faculty Mtg. (1:55-2:55) – WASC Focus groups
15 5- Day Schedule	16 1-6	17 7-4 NJROTC Principal’s Review in Gym Faculty Mtg. (1:55-2:55)	18 5-3	19 4-1 Faculty Mtg. (1:55-2:55) - WASC	20 2-7	21
22 3-Day Schedule	23 1-5	24 6-2 Faculty Mtg. (1:55-2:55)	25 3-7	26 HOLIDAY – No School	27 HOLIDAY – No School	28
29 5-Day Schedule – SBAC math testing	30 1-6	Notes: FINAL - 9/24/15				

Kalaheo High School Calendar
December 2015

~ December 2015 ~						
Sun	Mon	Tue	Wed	Thu	Fri	Sat
FINAL – 9/24/15 5-Day Schedule – SBAC math testing		1 7-4 KIS 8 th grade visit Mtg (1:55-2:55) - OLT	2 5-3	3 4-1 Dept. Mtg. (1:55-2:55) - Ops	4 2-7	5
6 Event Schedule	7 1-5 Blood Drive	8 6-2 Faculty Mtg.(1:55-2:55) – Final Schedule & Lesson Plans	9 3, P, 4, 5, 6 PTP Day	10 7-3 Faculty Mtg.(1:55-2:55) – Ac/Fin	11 4, 5, E, 6, 7	12 NJROTC Military Ball
13 FINAL SCHEDULE	14 1, 1, 2, 2, P PTP Day 6:30 pm AP Parent Night	15 3, 3, 4, 4, 5, 5	16 6, 6, 7, 7, 1	17 2-7	18 WINTER BREAK	19
20	21 	22	23	24	25	26
27	28 	29	30	31	Notes:	

Kalaheo High School Calendar
January 2016

~ January 2016 ~						
Sun	Mon	Tue	Wed	Thu	Fri	Sat
FINAL – 12/8/15					1 WINTER BREAK	2
3 3-Day Schedule	4 WINTER BREAK	5 Teachers’ Workday – No students	6 1-5	7 6-2	8 3-7	9 Grades due by 3 pm
10 5-Day Schedule	11 1-6 Grade verification due by 3 pm	12 7-4 Kikuchi in H202 for SBAC. EXT. Faculty Mtg. (1:55-3:55 pm) - RTI	13 5-3 Tan in H202 for SBAC.	14 4-1 Tan in H202 for SBAC. Faculty Mtg. (1:55-2:55 pm) - RTI	15 2-7 Gather & Grind Event @ 4:30 – 8:00 pm	16
17 4-Day Schedule	18 HOLIDAY	19 1-6	20 7-4 Math Dept. PD Day EXT. Faculty Mtg. (1:55-3:55 pm) - RTI	21 5, 6, P, 7, 1, 2 PTP Day	22 3-7 BLOOD DRIVE Faculty Mtg. (1:55-2:55 pm) - RTI	23
24 5-Day Schedule – SBAC math testing	25 1-6	26 7-4 OLT Mtg. (1:55-2:55 pm) - Lines	27 5-3	28 4-1 Dept. Mtg. (1:55-2:55 pm) - Lines	29 2-7	30
31	Notes: ELL ACCESS Testing Jan. 19-Feb. 26 1:1 Registration in Science – Jan. 17-29. Counselors NOT in their offices.					

Kalaheo High School Calendar
February 2016

~ February 2016 ~						
Sun	Mon	Tue	Wed	Thu	Fri	Sat
FINAL – 12/8/15 4-day week	1 PD Day – no students am – writing & articulation pm - operational	2 1-6	3 7-4	4 5, 6, P, 7, 1, 2 PTP Day	5 3-7 Conference Mtgs (1:55-2:55 pm)	6
7 Event Schedule	8 1-5 Mid-Qtr. 3 Grades due by 3 pm	9 6-2 Faculty Mtg. (1:55-2:55 pm) – 11 th grade ACT pre-bubbling	10 3, P, 4, 5, 6 PTP Day – 11 th grade ACT Pre-bubbling	11 7-3 Faculty Mtg. (1:55-2:55 pm)	12 4, 5, E, 6, 7 Drug Free Assembly Gather & Grind Event @ 4:30 – 8:00 pm	13
14 4-day week	15 HOLIDAY	16 1-6	17 7-4 EXT. Faculty Mtg. (1:55-3:55 pm) – WASC review	18 5, 6, P, 7, 1, 2 PTP Day – 11 th grade ACT Pre-bubbling	19 3-7	20
21 5-day week – SBAC math testing	22 1-6 WASC Visit ART with WASC (3-4 pm) Parents with WASC (4-5 pm)	23 7-4 WASC Visit ART (2-3 pm) Faculty Mtg. (2:55-3:55 pm) – WASC	24 5-3 WASC Visit Faculty Mtg. (2:55-3:55 pm) - WASC	25 4-1 WASC Visit EXT. Faculty Mtg. (1:55-3:25 pm) – WASC & ACT (9 th -11 th) test admin. inservice	26 2-7	27
28 MODIFIED 4-day week	29 1-5 1:50-2:30 pm-EXT. Faculty Mtg.-Reminders & ACT room set up	Notes: Kalaheo Art Exhibit in the Library Feb. 2-29, 2016 ACT Aspire (grades 9 & 10) Pre-Printed labels and test materials to arrive – February 15-17 ACT (grade 11) Nonsecure Materials to arrive – Feb. 1-4 ACT (grade 11) Secure Materials to arrive – Feb. 22-25				

Kalaheo High School Calendar
March 2016

~ March 2016 ~						
Sun	Mon	Tue	Wed	Thu	Fri	Sat
FINAL – 12/8/15 MODIFIED 4-day week		1 ACT and ACT Aspire Exams (grades 9-11) 12 th grade event	2 6-4	3 5-2 OLT Mtg. (1:55-2:55 pm)	4 3, 4, P, 5, 6, 7 PTP Day	5
		6	7 1-6	8 7-4	9 5-3	10 4-1
6 5-day week		8 Dept. Mtg. (1:55-2:55 pm)		10 Faculty Mtg. (1:55-2:55 pm)		12
13 2-day week	14 1, CF, CF, P, 2	15 3-7 ACT Make-Up Exam	16 NJROTC Spring Camp	17 NJROTC Spring Camp	18	19
20	21 	22	23	24	25 HOLIDAY	26
27 4-day week	28 HOLIDAY	29 1-6	30 7-4 Blood Drive Mtg.	31 5, 6, P, 7, 1, 2 PTP Day	Notes: Inservice Mtg. for SBAC???	